

SIDEWALK (COMMERCIAL - INDUSTRIAL)

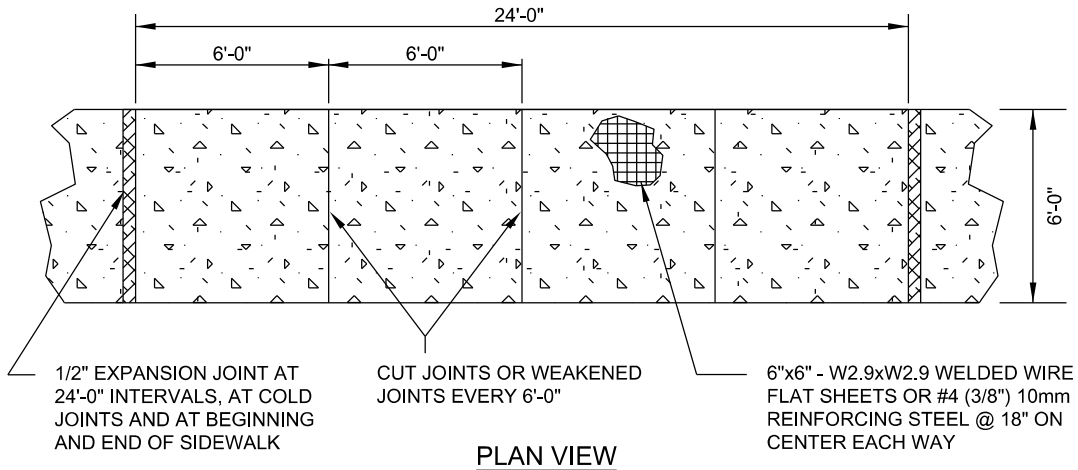

1/2" EXPANSION JOINT AT 24'-0" INTERVALS, AT COLD JOINTS AND AT BEGINNING AND END OF SIDEWALK

CUT JOINTS OR WEAKENED JOINTS EVERY 6'-0"

6"x6" - W2.9xW2.9 WELDED WIRE FLAT SHEETS OR #4 (3/8") 10mm REINFORCING STEEL @ 18" ON CENTER EACH WAY

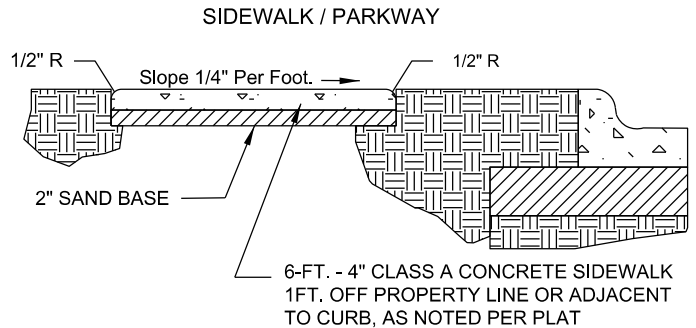
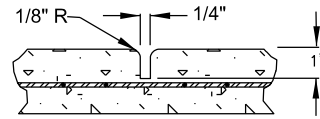
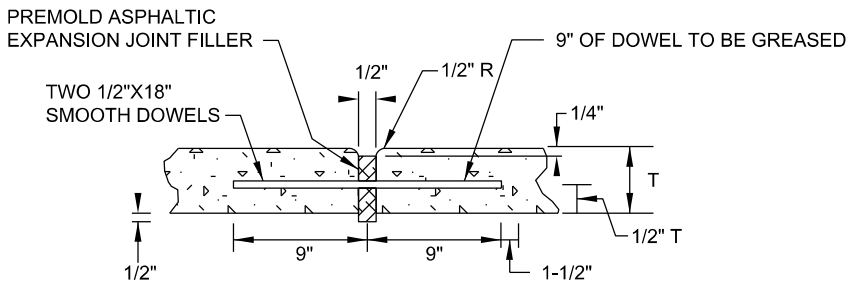

NOTES:

1. EXPANSION JOINTS ARE TO BE USED BETWEEN CONCRETE DRIVEWAY AND SIDEWALK.
2. SCORED JOINTS DENOTE SIDEWALK ACROSS THE DRIVEWAY AND ARE TO BE PLACED AT LEAST 1/3 rd. THROUGH THE SLAB THICKNESS.
3. ALL SIDEWALK AND DRIVEWAY CONSTRUCTION SHALL MEET A.D.A. SPECIFICATIONS.

DATE APPROVED: 07/2008	DWG. NO: ST-017	SCALE: N.T.S.
DRAWN BY: RAS	SHEET: 1 OF 1	
FILENAME: SIDEWALK (COMMERCIAL - INDUSTRIAL)		



**ENGINEERING
DEPARTMENT**